

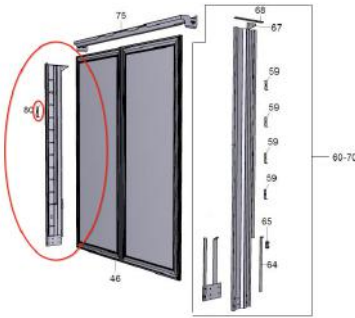

# SPARE PARTS CURTAINSIDER

All of the original components and consumables are stored in our warehouses Germany, Russia and Turkey. This stock also includes original parts obtained from system partners and leading suppliers.

REAR DOOR HINGE  
PART NUMBER | 11253000018



CATEGORY|UPPER STRUCTURE

ROOF RUBBER (GREY)  
PART NUMBER | 21171000060



CATEGORY|UPPER STRUCTURE

ROOF RAIL AL. PROFILE  
PART NUMBER | 11230101014

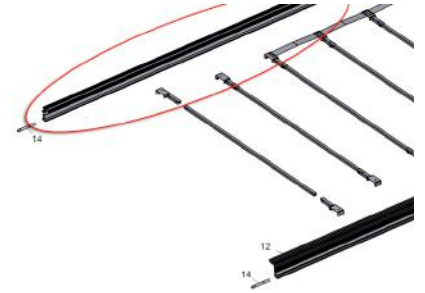

CATEGORY|UPPER STRUCTURE

SIDE PROFILE HOUSING  
PART NUMBER | 11370053055



CATEGORY|UPPER STRUCTURE

DROP SIDE AL. PROFILE (UPPER)  
PART NUMBER | 11090136405

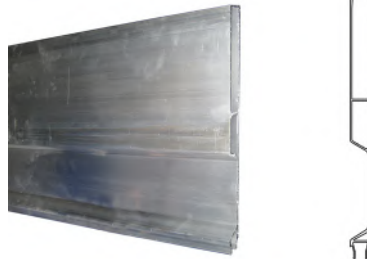

CATEGORY|UPPER STRUCTURE

DROP SIDE AL. PROFILE (LOWER)  
PART NUMBER | 11090139405

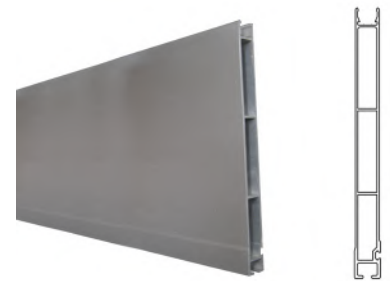

CATEGORY|UPPER STRUCTURE

HINGE COVER  
PART NUMBER | 11253000026



CATEGORY|UPPER STRUCTURE

HINGE CONNECTION PART  
PART NUMBER | 11254000001



CATEGORY|UPPER STRUCTURE

LOCK  
PART NUMBER | 11251000191



CATEGORY|UPPER STRUCTURE



# SPARE PARTS CURTAINSIDER

T-FORM LOCK  
PART NUMBER | 11251000192



CATEGORY | UPPER STRUCTURE

DROP SIDE AL. PROFILE  
PART NUMBER | 11090120416

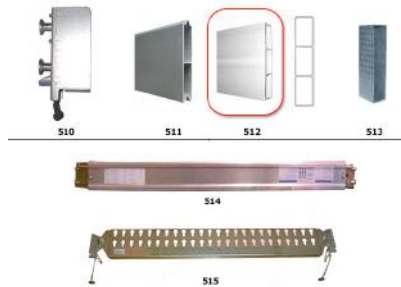

CATEGORY | UPPER STRUCTURE

CURTAIN STRAINING  
MECHANISM (RIGHT)  
PART NUMBER | 21513030011



CATEGORY | UPPER STRUCTURE

CURTAIN STRAINING  
MECHANISM (LEFT)  
PART NUMBER | 21513030012



CATEGORY | UPPER STRUCTURE

FORKLIFT BARRIER 400 MM.  
PART NUMBER | 11171000569



CATEGORY | UPPER STRUCTURE

RAIN GUTTER  
PART NUMBER | 11090129230



CATEGORY | UPPER STRUCTURE

RUBBER DAMPER  
PART NUMBER | 11171000221



CATEGORY | UPPER STRUCTURE

TOOLBOX  
PART NUMBER | 21080100075



CATEGORY | UPPER STRUCTURE

COUPLING CONNECTION SHEET  
PART NUMBER | 11279900046



CATEGORY | UPPER STRUCTURE



# SPARE PARTS CURTAINSIDER

VARIOMASTER PILLAR BEARING  
PART NUMBER | 21370152011



CATEGORY | UPPER STRUCTURE

LIFT MASTER  
PART NUMBER | 21235100035



CATEGORY | UPPER STRUCTURE

BOARDWAND ALU.  
PROFILDROP SIDE AL. PROFILE  
PART NUMBER | 11230101015



CATEGORY | UPPER STRUCTURE

DROP SIDE AL. PROFILE  
PART NUMBER | 11090125416

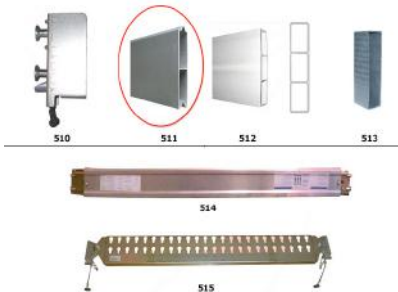

CATEGORY | UPPER STRUCTURE

PLASTIC SWITCHES WITH  
CLEARANCE  
PART NUMBER | 21239990020



CATEGORY | UPPER STRUCTURE

PLASTIC CHOCK DOOR  
PART NUMBER | 11369000013

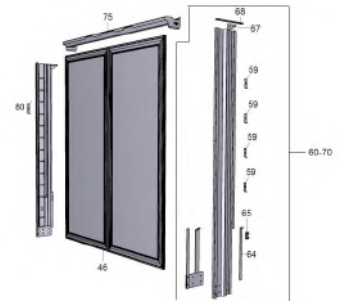

CATEGORY | UPPER STRUCTURE

REAR DOOR (RAL-9006)  
PART NUMBER | 11363042680

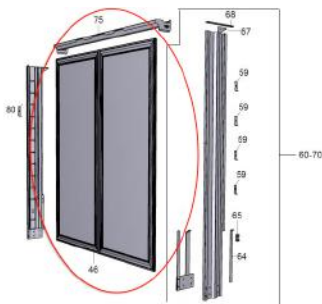

CATEGORY | UPPER STRUCTURE

REAR DOOR (RAL-9016)  
PART NUMBER | 11361542650

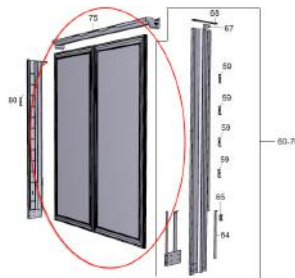

CATEGORY | UPPER STRUCTURE

VARIOMASTER PILLAR BEARING  
PART NUMBER | 21370152011



CATEGORY | UPPER STRUCTURE



# SPARE PARTS CURTAINSIDER

SAFETY STRAINING PROFILE  
PART NUMBER | 32929330010



CATEGORY | UPPER STRUCTURE

ADAPTER (UPPER)  
PART NUMBER | 21513020020



CATEGORY | UPPER STRUCTURE

ADAPTER (LOWER)  
PART NUMBER | 21513020030



CATEGORY | UPPER STRUCTURE

STRAINING PROFILE (FRONT)  
PART NUMBER | 11513010010



CATEGORY | UPPER STRUCTURE

STRAINING PROFILE (LONG)  
PART NUMBER | 11513010040



CATEGORY | UPPER STRUCTURE

SLIDING ROOF  
(WITH CLEARANCE)  
PART NUMBER | 21230001186



CATEGORY | UPPER STRUCTURE

SIDE PANEL PROFILE (RIGHT)  
PART NUMBER | 30686110001



CATEGORY | UPPER STRUCTURE

SIDE PANEL PROFILE (LEFT)  
PART NUMBER | 30686120001



CATEGORY | UPPER STRUCTURE

SLIDING LADDER  
PART NUMBER | 11520700052

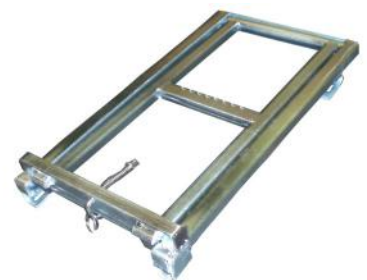

CATEGORY | UPPER STRUCTURE



# SPARE PARTS CURTAINSIDER

SLIDING ROOF  
(WITHOUT CLEARANCE)  
PART NUMBER | 21230001021



CATEGORY | UPPER STRUCTURE

SIDE PROFILE HOUSING (LEFT)  
PART NUMBER | 21370353000



CATEGORY | UPPER STRUCTURE

SIDE PROFILE HOUSING (RIGHT)  
PART NUMBER | 21370353001



CATEGORY | UPPER STRUCTURE

RAIN GUTTER (RU17181)  
PART NUMBER | 10309000120



CATEGORY | UPPER STRUCTURE

RAIN GUTTER (RU17351)  
PART NUMBER | 10309000124



CATEGORY | UPPER STRUCTURE

MIDDLE PILLAR  
PART NUMBER | 21370302012



CATEGORY | UPPER STRUCTURE

FIXED TELESCOPE  
PART NUMBER | 21370304000

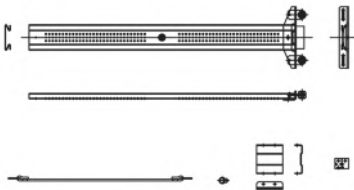

CATEGORY | UPPER STRUCTURE

AL. FRONT PILLAR BAR (RIGHT)  
PART NUMBER | 30109004528



CATEGORY | UPPER STRUCTURE

FOLDING PILLAR 600MM  
PART NUMBER | 11370001002



CATEGORY | UPPER STRUCTURE



# SPARE PARTS CURTAINSIDER

STANDARD VARIO MASTER  
**PART NUMBER |**  
**STD\_V\_MSTR\_900L7\_Y**



**CATEGORY** | UPPER STRUCTURE

MIDDLE PILLAR LIGHT TYP  
GROUP  
**PART NUMBER |**  
**O\_BABA\_ADAICO\_Y**



**CATEGORY** | UPPER STRUCTURE



# SPARE PARTS CURTAINSIDER

TYRE CHOCK  
PART NUMBER | 21520400025



CATEGORY | LOWER STRUCTURE

SEMI MUDGUARD  
PART NUMBER | 21210100029



CATEGORY | LOWER STRUCTURE

MUDGUARD PIPE WITH BOLTS  
PART NUMBER | 11211000031



CATEGORY | LOWER STRUCTURE

MUDGUARD PIPE Ø36  
PART NUMBER | 11172000125



CATEGORY | LOWER STRUCTURE

SIDE PROTECTION HOLDER KIT  
PART NUMBER | 11282000011



CATEGORY | LOWER STRUCTURE

SPARE WHEEL HOLDER  
PART NUMBER | 11240101055



CATEGORY | LOWER STRUCTURE

SPARE WHEEL  
PART NUMBER | 11240201043



CATEGORY | LOWER STRUCTURE

AIR BAG  
PART NUMBER | 11138105003

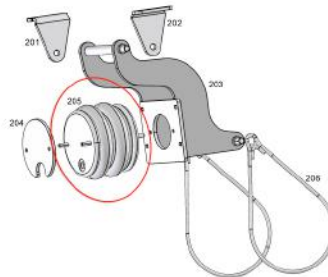

CATEGORY | LOWER STRUCTURE

LIFTING AXLE  
PART NUMBER | 11000000030

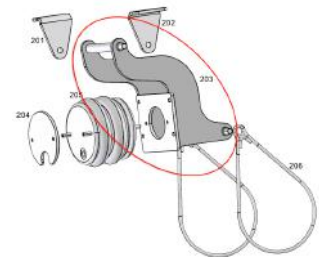

CATEGORY | LOWER STRUCTURE



# SPARE PARTS CURTAINSIDER

SHOCK ABSORBER  
PART NUMBER | 21330000035

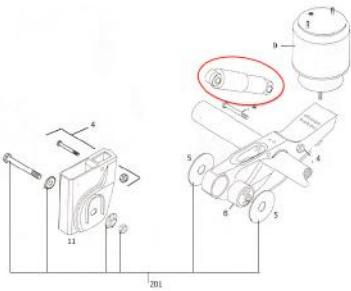

CATEGORY | LOWER STRUCTURE

LIFTING AXLE VALVE  
PART NUMBER | 21153104060



CATEGORY | LOWER STRUCTURE

EBS MODULATOR  
PART NUMBER | 21150110177



CATEGORY | LOWER STRUCTURE

BRAKE VALVE  
PART NUMBER | 21151103199



CATEGORY | LOWER STRUCTURE

KING PIN  
PART NUMBER | 21200000030



CATEGORY | LOWER STRUCTURE

LANDING GEAR GROUP  
PART NUMBER | 31102006109



CATEGORY | LOWER STRUCTURE

LANDING GEAR  
PART NUMBER | 31343011012



CATEGORY | LOWER STRUCTURE

LIFTING AIRBAG SHEET  
PART NUMBER | 11040000832

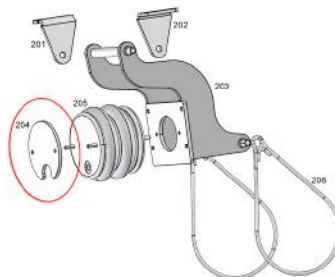

CATEGORY | LOWER STRUCTURE

LIFTAXLE HANGER PART  
PART NUMBER | 11040000023

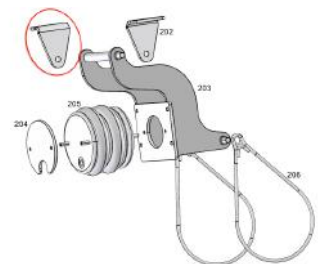

CATEGORY | LOWER STRUCTURE





# SPARE PARTS CURTAINSIDER

END OUTLINE MARKER LIGHT  
CONNECTING BRACKET (LEFT)  
PART NUMBER | 10118122106

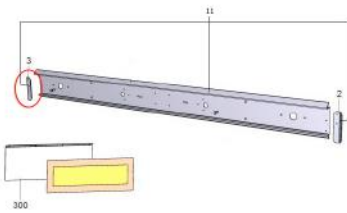

CATEGORY | LOWER STRUCTURE

END OUTLINE MARKER LIGHT  
CONNECTING BRACKET (RIGHT)  
PART NUMBER | 10118122105

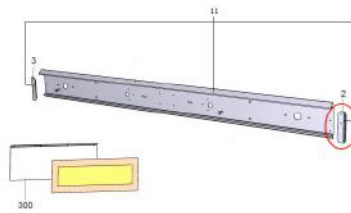

CATEGORY | LOWER STRUCTURE

BUMPER (PAINTED)  
PART NUMBER | 11522099110

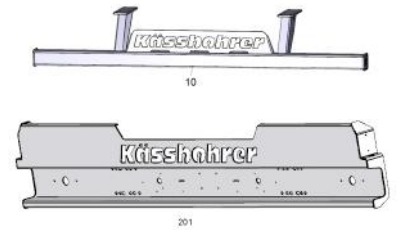

CATEGORY | LOWER STRUCTURE

SIDE PROTECTION PROFILE  
400MM (FRONT)  
PART NUMBER | 31000058400



CATEGORY | LOWER STRUCTURE

SIDE PROTECTION PLASTIC CAP  
AL. CLOSURE (LEFT)  
PART NUMBER | 11172000241

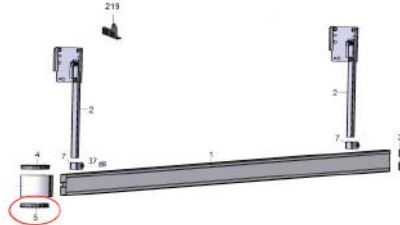

CATEGORY | LOWER STRUCTURE

SIDE PROTECTION PLASTIC CAP  
AL. CLOSURE (RIGHT)  
PART NUMBER | 11172000242



CATEGORY | LOWER STRUCTURE

AL. SIDE PROTECTION CLAMP  
PART NUMBER | 1206000008



CATEGORY | LOWER STRUCTURE

SIDE PROTECTION PLASTIC CAP  
PART NUMBER | 11172000243



CATEGORY | LOWER STRUCTURE

RAISING LOWERING VALVE  
PART NUMBER | 21151103110



CATEGORY | LOWER STRUCTURE



# SPARE PARTS CURTAINSIDER

MANOMETER  
PART NUMBER | 11149999998



CATEGORY | LOWER STRUCTURE

WATER DISCHARGE VALVE  
PART NUMBER | 21151102100



CATEGORY | LOWER STRUCTURE

LEVEL VALVE  
PART NUMBER | 21151103151



CATEGORY | LOWER STRUCTURE

BRIDGESTONE TIRE 385/65 R  
22.5 120 WITH OFFSET  
PART NUMBER | 31160000080



CATEGORY | LOWER STRUCTURE

TAIL LAMP PROFILE  
PART NUMBER | 11095099175



CATEGORY | LOWER STRUCTURE



# SPARE PARTS CURTAINSIDER

MOVING HOOK (LONG)  
PART NUMBER | 11220000010



CATEGORY|CHASSIS & PLATFORM

FIXED HOOK  
PART NUMBER | 11220000020



CATEGORY|CHASSIS & PLATFORM

PLYWOOD GROUP  
PART NUMBER | 21110300023

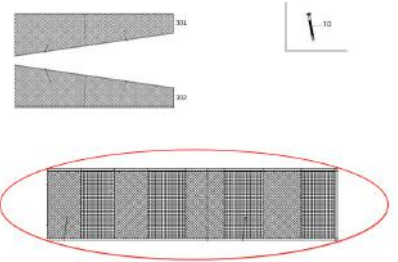

CATEGORY|CHASSIS & PLATFORM

PLYWOOD BOLT 70 mm.  
PART NUMBER | 22040200015



CATEGORY|CHASSIS & PLATFORM

SIDE RAVE  
PART NUMBER | 34100001542



CATEGORY|CHASSIS & PLATFORM

PLYWOOD BOLT 6.3NCX38  
PART NUMBER | 22040200018



CATEGORY|CHASSIS & PLATFORM

FRONT TRAVERSE  
PART NUMBER | 11270100300



CATEGORY|CHASSIS & PLATFORM



# SPARE PARTS CURTAINSIDER

LIFTING AXLE CABLE  
PART NUMBER | 21151102184

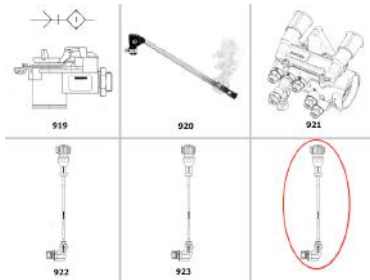

CATEGORY | ELEKTRICAL GROUP

SIDE LIGHT CABLE  
PART NUMBER | 21180199926



CATEGORY | ELEKTRICAL GROUP

SIDE LIGHT  
PART NUMBER | 21180320115



CATEGORY | ELEKTRICAL GROUP

END OUTLINE MARKER LAMP  
(RIGHT)  
PART NUMBER | 21180320910



CATEGORY | ELEKTRICAL GROUP

END OUTLINE MARKER LAMP  
(LEFT)  
PART NUMBER | 21180320920



CATEGORY | ELEKTRICAL GROUP

STOP LAMP (RIGHT)  
PART NUMBER | 21180329932



CATEGORY | ELEKTRICAL GROUP

STOP LAMP (LEFT)  
PART NUMBER | 21180329933



CATEGORY | ELEKTRICAL GROUP

FRONT POSITION LIGHT  
PART NUMBER | 21180329954



CATEGORY | ELEKTRICAL GROUP

PLATE LAMP  
PART NUMBER | 21180401044



CATEGORY | ELEKTRICAL GROUP



# SPARE PARTS CURTAINSIDER

PLASTIC COVER FOR LIGHT  
PART NUMBER | 21180320318



CATEGORY | ELEKTRICAL GROUP

MAIN CABLE  
PART NUMBER | 21180199936



CATEGORY | ELEKTRICAL GROUP

EBS CABLE  
PART NUMBER | 21150110122

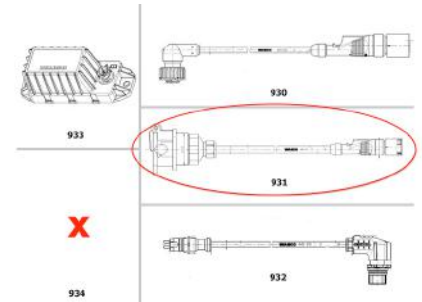

CATEGORY | ELEKTRICAL GROUP



# SPARE PARTS CURTAINSIDER

ROPE  
PART NUMBER | 12090100018

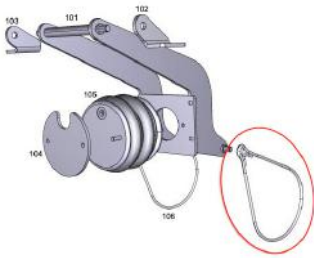

CATEGORY|ACCESSORIES

BLANK PLUG  
PART NUMBER | 21151102109



CATEGORY|ACCESSORIES

BOLT-DIN912-M8\*20-8.8  
PART NUMBER | 12010108020



CATEGORY|ACCESSORIES

RIVET-DIN660A-M4\*12  
PART NUMBER | 12050104012



CATEGORY|ACCESSORIES

LABEL  
PART NUMBER | 21150110021



CATEGORY|ACCESSORIES

RED STICKER KAESSBOHRER  
(LARGE)  
PART NUMBER | 11520100223



CATEGORY|ACCESSORIES

RED STICKER KASSBOHRER  
(SMALL)  
PART NUMBER | 11520100335



CATEGORY|ACCESSORIES

FOLYO STICKER REFLECTOR  
PART NUMBER | 21520300061



CATEGORY|ACCESSORIES

EBS-LABEL  
PART NUMBER | 21150110142

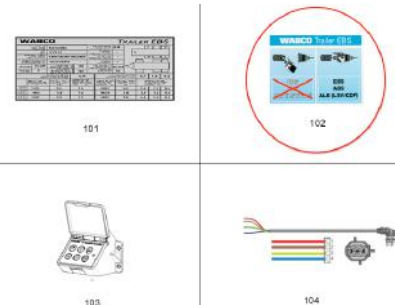

CATEGORY|ACCESSORIES



## SPARE PARTS CURTAINSIDER

REFLECTOR WHITE  
PART NUMBER | 11180900030



CATEGORY|ACCESSORIES

REFLECTOR RED  
PART NUMBER | 11180900040



CATEGORY|ACCESSORIES

REFLECTOR YELLOW  
PART NUMBER | 11180900041



CATEGORY|ACCESSORIES

WHEEL CHOCK HOLDER PIN  
PART NUMBER | 11520490001

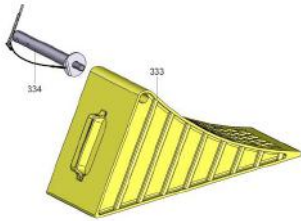

CATEGORY|ACCESSORIES

COUPLING RED  
PART NUMBER | 21151103102



CATEGORY|ACCESSORIES

COUPLING YELLOW  
PART NUMBER | 21151103103



CATEGORY|ACCESSORIES

GALVANIZED FOUR CORNERED  
M8 NUT  
PART NUMBER | 12020600081



CATEGORY|ACCESSORIES

NEW TYP BOX LOCK  
PART NUMBER | 11081000011



CATEGORY|ACCESSORIES

MUDGARD CLAMP  
PART NUMBER | 11211100052



CATEGORY|ACCESSORIES



# SPARE PARTS CURTAINSIDER

ANTISPREY MATTRESS  
PART NUMBER | 21212000066



CATEGORY|ACCESSORIES

FIRE CABINET  
PART NUMBER | 11080500512



CATEGORY|ACCESSORIES

BLIND PLUG  
PART NUMBER | 21151102110



CATEGORY|ACCESSORIES





## SPARE PARTS LOW-BED

All of the original components and consumables are stored in our warehouses Germany, Russia and Turkey. This stock also includes original parts obtained from system partners and leading suppliers.

RAMP SHORT (LEFT)  
PART NUMBER | 10109007270



CATEGORY | UPPER STRUCTURE

RAMP SHORT (RIGHT)  
PART NUMBER | 10109007271



CATEGORY | UPPER STRUCTURE

END RAMP (LEFT)  
PART NUMBER | 10109007280



CATEGORY | UPPER STRUCTURE

END RAMP (RIGHT)  
PART NUMBER | 10109007281



CATEGORY | UPPER STRUCTURE



# SPARE PARTS LOW-BED

BRAKE CHAMBER (TYP 20)  
PART NUMBER | 11151005020



CATEGORY | LOWER STRUCTURE

BRAKE CHAMBER (TYP 24)  
PART NUMBER | 11151005024



CATEGORY | LOWER STRUCTURE

SPRING BRAKE CHAMBER  
(TYP 24)  
PART NUMBER | 11151005124



CATEGORY | LOWER STRUCTURE

PZB 24DC 4CC 10LT TANK 2000  
WATT  
PART NUMBER | 11570000069



CATEGORY | LOWER STRUCTURE

HUBODOMETER  
PART NUMBER | 21141300100



CATEGORY | LOWER STRUCTURE

SELENOID VALVE  
PART NUMBER | 21145210024



CATEGORY | LOWER STRUCTURE

EBS CONTROL VALVE  
PART NUMBER | 21150110015



CATEGORY | LOWER STRUCTURE

EBS BRAKE VALVE  
PART NUMBER | 21150110046



CATEGORY | LOWER STRUCTURE

EBS MODULATOR 24 V  
PART NUMBER | 21150110185



CATEGORY | LOWER STRUCTURE



## SPARE PARTS LOW-BED

2 WAY VALVE  
PART NUMBER | 21151103040



CATEGORY | LOWER STRUCTURE

PRESSURE SENSOR  
PART NUMBER | 21151103050



CATEGORY | LOWER STRUCTURE

DISCHARGE VALVE  
PART NUMBER | 21151103260



CATEGORY | LOWER STRUCTURE

PRESSURE CONTROL VALVE  
PART NUMBER | 21151103304



CATEGORY | LOWER STRUCTURE

BRAKE CHAMBER 24/24  
PART NUMBER | 21151105024



CATEGORY | LOWER STRUCTURE

BRAKE CHAMBER (TYP 24)  
PART NUMBER | 21151105025



CATEGORY | LOWER STRUCTURE

LIFTING AXLE VALVE  
PART NUMBER | 21153104010



CATEGORY | LOWER STRUCTURE

SPARE WHEEL CONNECTING SET  
PART NUMBER | 11240299010



CATEGORY | LOWER STRUCTURE

MECHANIC LEG (REAR)  
PART NUMBER | 10109001144



CATEGORY | LOWER STRUCTURE



## SPARE PARTS LOW-BED

RAMP CONNECTING BRACKET  
PART NUMBER | 10109001661

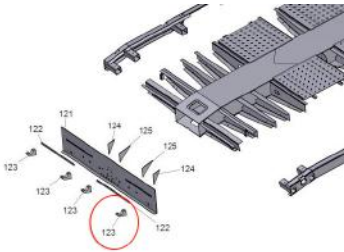

CATEGORY | LOWER STRUCTURE

BREMBALGEN (TYP 24) BRAKE  
CHAMBER (TYP 24)  
PART NUMBER | 11151005224



CATEGORY | LOWER STRUCTURE

SIDE PROTECTION PLASTIC CAP  
AL. CLOSURE (LEFT)  
PART NUMBER | 11172000241

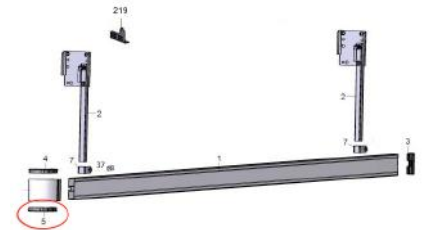

CATEGORY | LOWER STRUCTURE

SIDE PROTECTION PLASTIC CAP  
AL. CLOSURE (RIGHT)  
PART NUMBER | 11172000242



CATEGORY | LOWER STRUCTURE

AL. SIDE PROTECTION CLAMP  
PART NUMBER | 12060000008



CATEGORY | LOWER STRUCTURE

SIDE PROTECTION PLASTIC CAP  
PART NUMBER | 11172000243



CATEGORY | LOWER STRUCTURE

RAISING LOWERING VALVE  
PART NUMBER | 21151103110



CATEGORY | LOWER STRUCTURE

MANOMETER  
PART NUMBER | 11149999998



CATEGORY | LOWER STRUCTURE

WATER DISCHARGE VALVE  
PART NUMBER | 21151102100



CATEGORY | LOWER STRUCTURE



# SPARE PARTS LOW-BED

RAMP CONNECTING BRACKET  
PART NUMBER | 10109001661

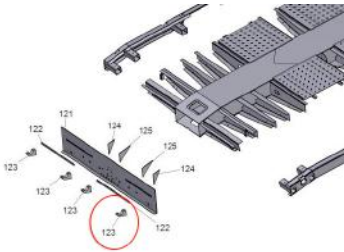

CATEGORY | LOWER STRUCTURE

BRIDGESTONE TIRE 385/65 R  
22.5 120 WITH OFFSET  
PART NUMBER | 31160000080



CATEGORY | LOWER STRUCTURE

TAIL LAMP PROFILE  
PART NUMBER | 11095099175



CATEGORY | LOWER STRUCTURE



# SPARE PARTS LOW-BED

HYDROULIC CYLINDER Ø80  
(RIGHT)  
PART NUMBER | 11570000063



CATEGORY|CHASSIS & PLATFORM

HYDROULIC CYLINDER Ø80  
(LEFT)  
PART NUMBER | 11570000084



CATEGORY|CHASSIS & PLATFORM

LIFTED PROFILE  
PART NUMBER | 11570000119



CATEGORY|CHASSIS & PLATFORM

LOCKING BRACKETS-DRIVE  
PLATFORM  
PART NUMBER | 11570000083



CATEGORY|CHASSIS & PLATFORM

MUDGUARD BRACKET (LEFT)  
PART NUMBER | 10109009695

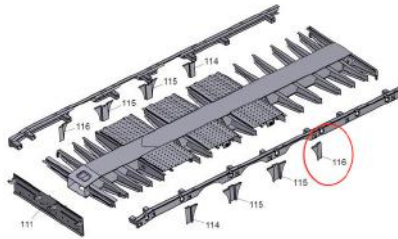

CATEGORY|CHASSIS & PLATFORM

MUDGUARD CLAMP (RIGHT)  
PART NUMBER | 10109009696

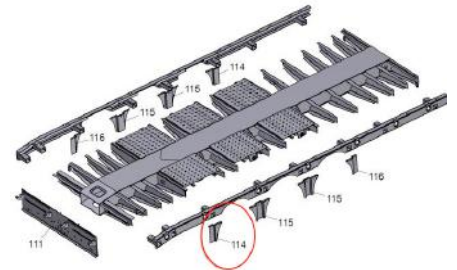

CATEGORY|CHASSIS & PLATFORM



# SPARE PARTS LOW-BED

CONNECTOR/FIS 160 A  
PART NUMBER | 11180499010



CATEGORY | ELEKTRICAL GROUP

ELEKTRICAL SPIRAL CABLE (4)  
PART NUMBER | 21180139991



CATEGORY | ELEKTRICAL GROUP

PARK LIGHT CABLE  
PART NUMBER | 21180199002



CATEGORY | ELEKTRICAL GROUP

CABLE WITH CONNECTOR  
PART NUMBER | 21180199910



CATEGORY | ELEKTRICAL GROUP

PARK LIGHT CABLE  
PART NUMBER | 21180199912



CATEGORY | ELEKTRICAL GROUP

MAIN CABLE  
PART NUMBER | 21180199991



CATEGORY | ELEKTRICAL GROUP

PARK LIGHT CABLE  
PART NUMBER | 21180320135



CATEGORY | ELEKTRICAL GROUP

FRONT POSITION LIGHT  
PART NUMBER | 21180320610



CATEGORY | ELEKTRICAL GROUP

WARNING LIGHT YELLOW  
(RIGHT-LEFT)  
PART NUMBER | 21180329929



CATEGORY | ELEKTRICAL GROUP



# SPARE PARTS LOW-BED

ELEKTRIC CONNECTOR WITH  
15 PIN  
PART NUMBER | 21180600075



CATEGORY | ELEKTRICAL GROUP

CONNECTION BOX  
PART NUMBER | 21180700007



CATEGORY | ELEKTRICAL GROUP

PLATE LAMP  
PART NUMBER | 21180320310



CATEGORY | ELEKTRICAL GROUP

EBS CABLE  
PART NUMBER | 21150110122

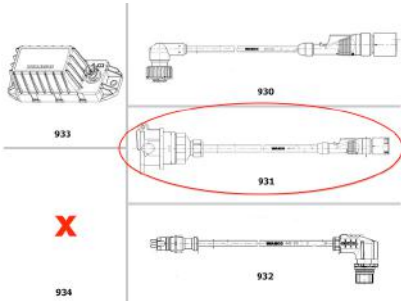

CATEGORY | ELEKTRICAL GROUP





# SPARE PARTS LOW-BED

REFLECTOR  
PART NUMBER | 21180900011



CATEGORY|ACCESSORIES

TYRE CHOCK  
PART NUMBER | 21520400024

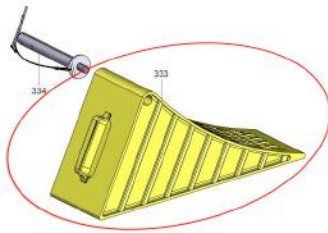

CATEGORY|ACCESSORIES

BOX CONTROL ARM  
PART NUMBER | 11081000013

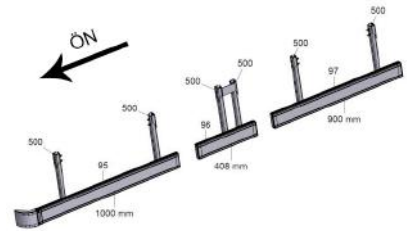

CATEGORY|ACCESSORIES

BOLT-DIN912-M8\*20-8.8  
PART NUMBER | 12010108020



CATEGORY|ACCESSORIES

RIVET-DIN660A-M4\*12  
PART NUMBER | 12050104012



CATEGORY|ACCESSORIES

LABEL  
PART NUMBER | 21150110021



CATEGORY|ACCESSORIES

RED STICKER KAESSBOHRER  
(LARGE)  
PART NUMBER | 11520100223



CATEGORY|ACCESSORIES

RED STICKER KASSBOHRER  
(SMALL)  
PART NUMBER | 11520100335



CATEGORY|ACCESSORIES

FOLYO STICKER REFLECTOR  
PART NUMBER | 21520300061



CATEGORY|ACCESSORIES



# SPARE PARTS LOW-BED

EBS-LABEL  
PART NUMBER | 21150110142

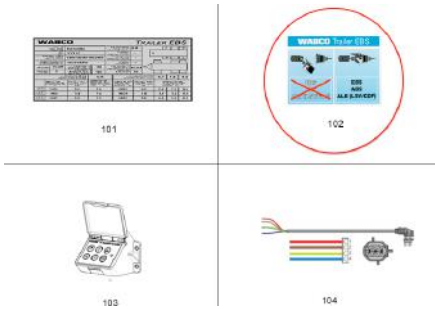

CATEGORY|ACCESSORIES

REFLECTOR WHITE  
PART NUMBER | 11180900030



CATEGORY|ACCESSORIES

REFLECTOR RED  
PART NUMBER | 11180900040



CATEGORY|ACCESSORIES

REFLECTOR YELLOW  
PART NUMBER | 11180900041



CATEGORY|ACCESSORIES

WHEEL CHOCK HOLDER PIN  
PART NUMBER | 11520490001

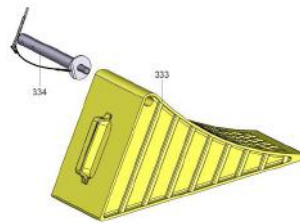

CATEGORY|ACCESSORIES

COUPLING RED  
PART NUMBER | 21151103102



CATEGORY|ACCESSORIES

COUPLING YELLOW  
PART NUMBER | 21151103103



CATEGORY|ACCESSORIES

GALVANIZED FOUR CORNERED  
M8 NUT  
PART NUMBER | 12020600081



CATEGORY|ACCESSORIES

NEW TYP BOX LOCK  
PART NUMBER | 11081000011



CATEGORY|ACCESSORIES



# SPARE PARTS LOW-BED

MUDGARD CLAMP  
PART NUMBER | 11211100052



CATEGORY|ACCESSORIES

ANTISPREY MATTRESS  
PART NUMBER | 21212000066



CATEGORY|ACCESSORIES

FIRE CABINET  
PART NUMBER | 11080500512



CATEGORY|ACCESSORIES

BLIND PLUG  
PART NUMBER | 21151102110



CATEGORY|ACCESSORIES